



**6 Belgrave Mews
Uxbridge, UB8 3AG**

£2,200 PCM

Deposit required £2,536

**Available date 15th August
2024**

****STUDENTS****

4 BEDROOMS - AVAILABLE 15/08/2024

The rental payments equate to approx £550 per person per month or £127 per person per week excluding bills.

UniHomes offer a bills package for £26 per person per week. (Incl Gas, Electric, Water, TV licence and internet) which can be organised through Nupad initially.

COUNCIL TAX BAND D
EPC C

Nupad offer this excellent FOUR-bedroom house comprising of FOUR FURNISHED BEDROOMS , a LOUNGE, BATHROOM AND KITCHEN facilities. The property is ideal for students at Brunel University as it's walking distance to the university. It is also nearby to direct bus routes to Uxbridge Town Centre, Heathrow, Stockley Park and the local underground station, which provides further access to Central London.

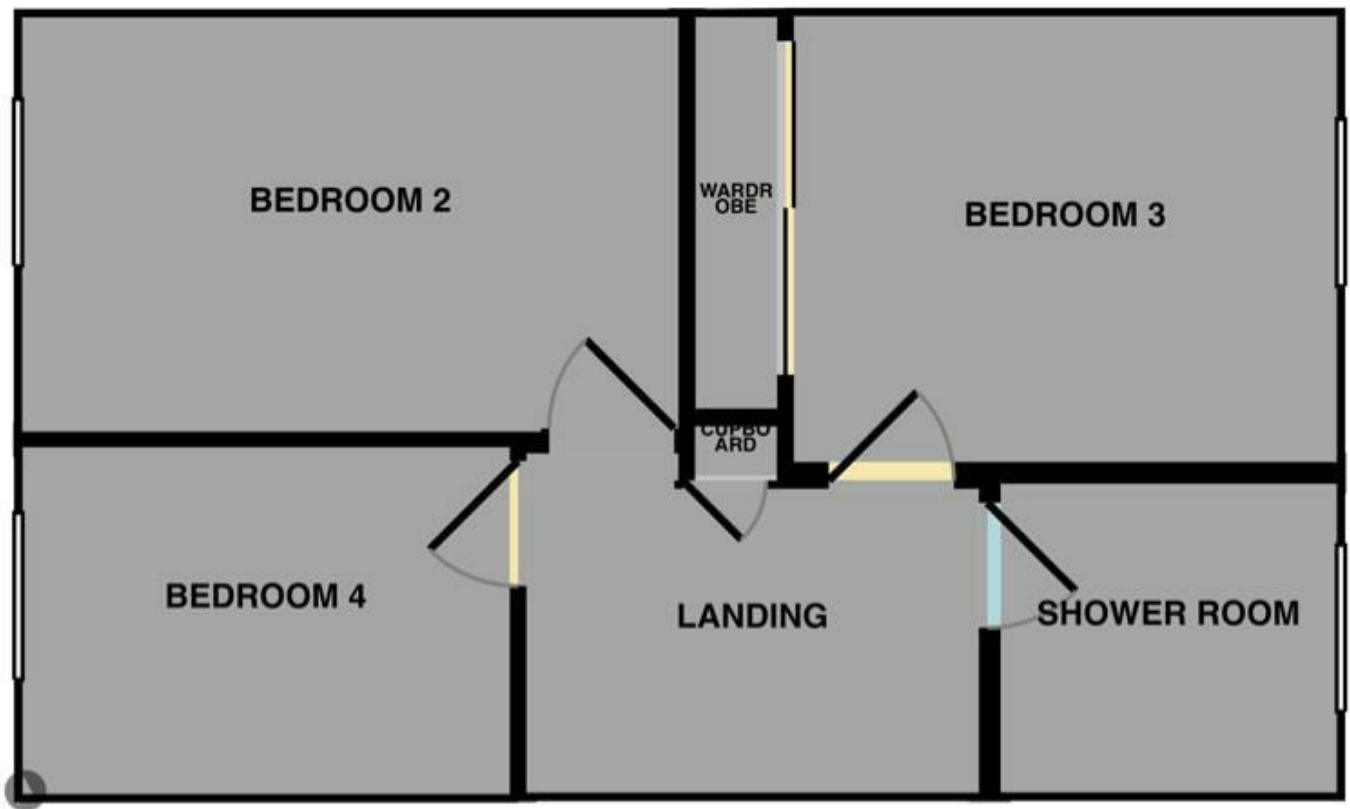
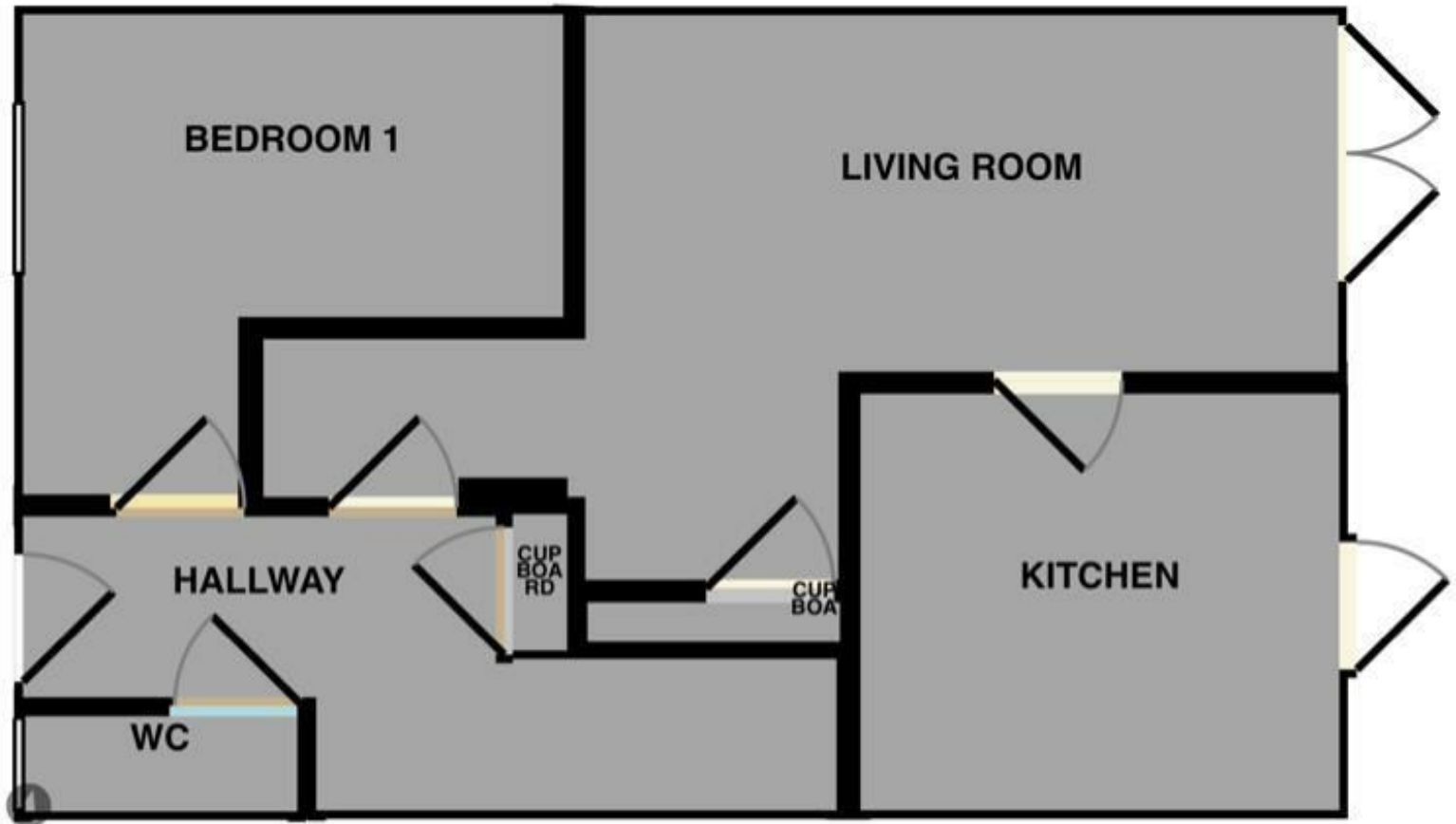

Energy Efficiency Rating		Current	Potential
Very energy efficient - lower running costs			
(92 plus) A			
(81-91) B			
(69-80) C			
(55-68) D			
(39-54) E			
(21-38) F			
(1-20) G			
Not energy efficient - higher running costs			
England & Wales		73	86
EU Directive 2002/91/EC			

Environmental Impact (CO ₂) Rating		Current	Potential
Very environmentally friendly - lower CO ₂ emissions			
(92 plus) A			
(81-91) B			
(69-80) C			
(55-68) D			
(39-54) E			
(21-38) F			
(1-20) G			
Not environmentally friendly - higher CO ₂ emissions			
England & Wales		73	86
EU Directive 2002/91/EC			