



**3 Cowley Mill Road  
Uxbridge, UB8 2QB  
£3,240 PCM**

**Deposit required £3,738**

**Available date 28th June  
2024**

**\*\*STUDENTS\*\***

**6 BEDROOMS - AVAILABLE 28/06/2024**

The rental payments equate to approx £540 per person per month or £125 per person per week excluding bills.

UniHomes offer a bills package for £22 per person per week. (Incl Gas, Electric, Water, TV licence and internet) which can be organised through Nupad initially.

Nupad offer this excellent SIX bedroom house comprising of SIX FURNISHED BEDROOMS , TWO BATHROOMS KITCHEN LIVING ROOM, rear GARDEN.

The property is ideal for students at Brunel University as it's close to campus. It is also nearby to direct bus routes to Uxbridge Town Centre, Heathrow, Stockley Park and the local underground station, which provides further access to Central London.

GROUND FLOOR  
760 sq.ft. (70.6 sq.m.) approx.

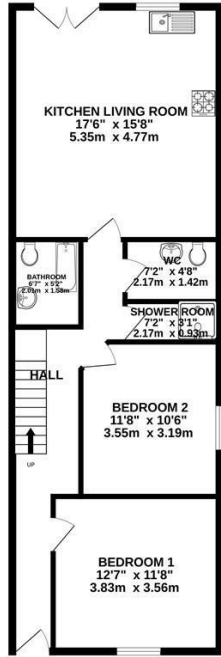

1ST FLOOR  
454 sq.ft. (42.2 sq.m.) approx.

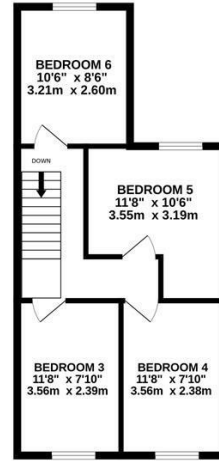

TOTAL FLOOR AREA: 1215 sq.ft. (112.8 sq.m.) approx.

While every attempt has been made to ensure the accuracy of the floorplan contained here, measurements of doors, windows, rooms and any other items are approximate and no responsibility is taken for any error, omission or mis-statement. This plan is for illustrative purposes only and should be used as such by any prospective purchaser. The services, systems and appliances shown have not been tested and no guarantee as to their operability or efficiency can be given.  
Made with Metropix C2024

Energy Efficiency Rating		Current	Potential
Very energy efficient - lower running costs			
(92 plus) <b>A</b>			
(81-91) <b>B</b>			
(69-80) <b>C</b>			
(55-68) <b>D</b>			
(39-54) <b>E</b>			
(21-38) <b>F</b>			
(1-20) <b>G</b>			
Not energy efficient - higher running costs			
<b>England &amp; Wales</b>	EU Directive 2002/91/EC	<b>66</b>	

Environmental Impact (CO <sub>2</sub> ) Rating		Current	Potential
Very environmentally friendly - lower CO <sub>2</sub> emissions			
(92 plus) <b>A</b>			
(81-91) <b>B</b>			
(69-80) <b>C</b>			
(55-68) <b>D</b>			
(39-54) <b>E</b>			
(21-38) <b>F</b>			
(1-20) <b>G</b>			
Not environmentally friendly - higher CO <sub>2</sub> emissions			
<b>England &amp; Wales</b>	EU Directive 2002/91/EC		