



**15 Montague Road  
Uxbridge, UB8 1QL  
£2,308 PCM**

**Deposit required £2,663**

**Available date 8th  
September 2025**

**\*\*STUDENTS\*\***

**4 BEDROOMS - AVAILABLE 8/09/2025**

The rental payments equate to approx £577 per person per month or £133 per person per week excluding bills.

UniHomes offer a bills package for £25 per person per week. (Incl Gas, Electric, Water, TV licence and internet) which can be organised through Nupad initially.

COUNCIL TAX BAND E  
EPC E

Nupad offer this excellent FOUR-bedroom house comprising of FOUR FURNISHED BEDROOMS , a LOUNGE, CONSERVATORY, upstairs BATHROOM with separate WC, downstairs SHOWER ROOM AND KITCHEN facilities, outside there is off street parking and rear gardens.

The property is ideal for students at Brunel University. It is also nearby to Uxbridge Town Centre, Heathrow, Stockley Park and the local underground station, which provides further access to Central London.

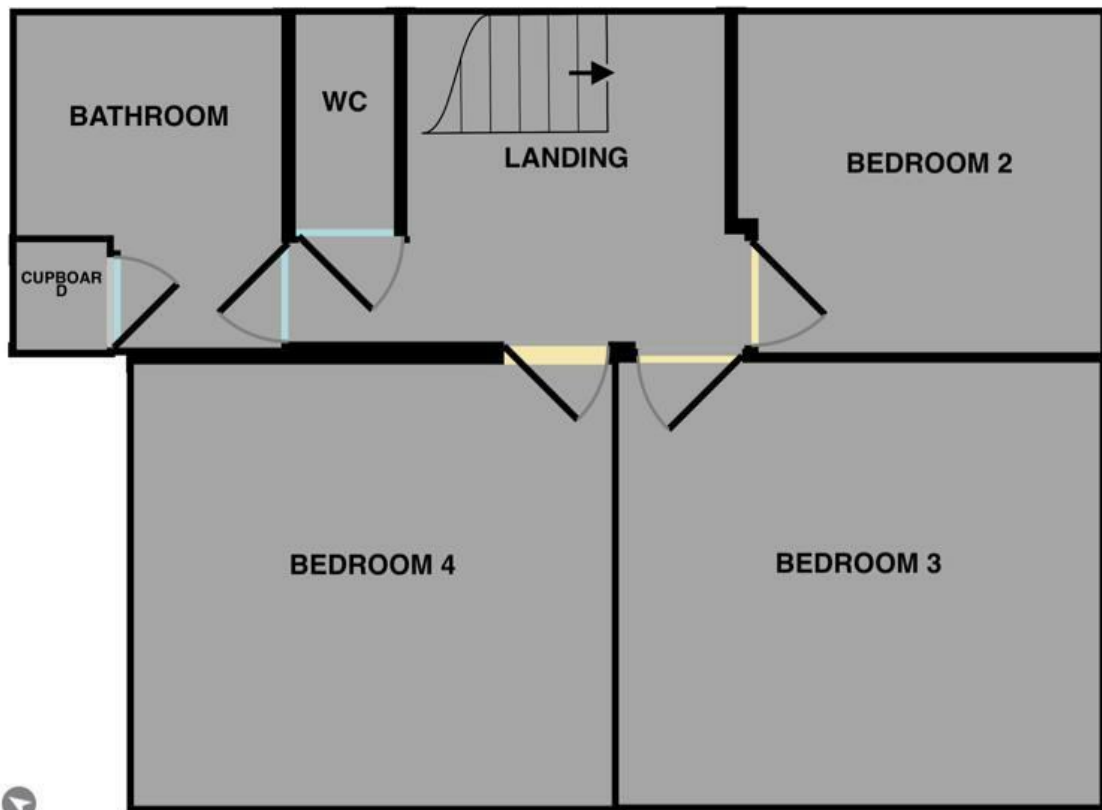
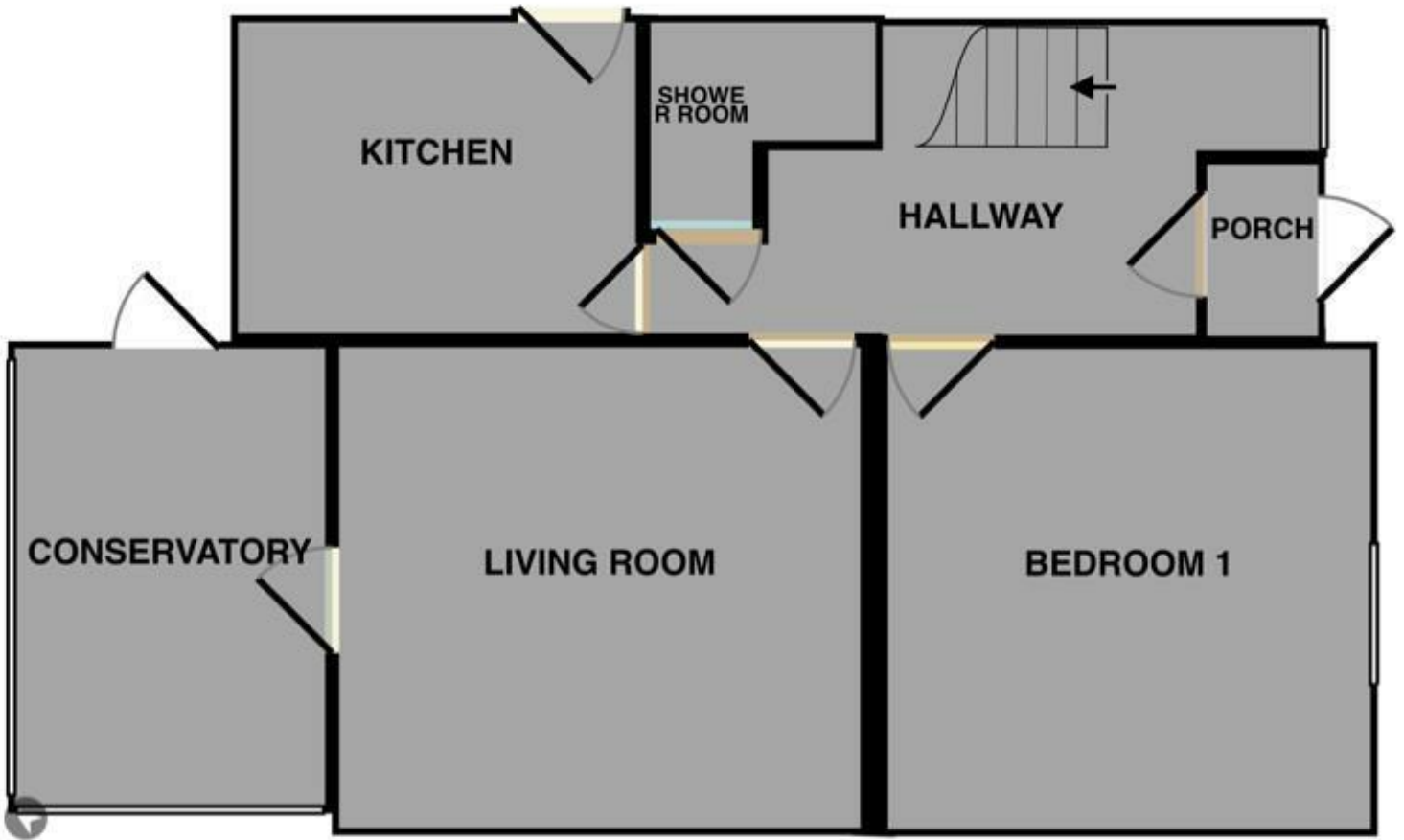

Energy Efficiency Rating	
	Potential
Very energy efficient - lower running costs	
(92 plus) <b>A</b>	
(81-91) <b>B</b>	
(69-80) <b>C</b>	
(55-68) <b>D</b>	
(39-54) <b>E</b>	
(21-38) <b>F</b>	
(1-20) <b>G</b>	
Not energy efficient - higher running costs	
Current: <b>51</b>	Potential: <b>77</b>
<small>EU Directive 2002/91/EC</small>	

Environmental Impact (CO <sub>2</sub> ) Rating	
	Potential
Very environmentally friendly - lower CO <sub>2</sub> emissions	
(92 plus) <b>A</b>	
(81-91) <b>B</b>	
(69-80) <b>C</b>	
(55-68) <b>D</b>	
(39-54) <b>E</b>	
(21-38) <b>F</b>	
(1-20) <b>G</b>	
Current: <b>51</b>	Potential: <b>53</b>
<small>EU Directive 2002/91/EC</small>	