



**2A Heath Court  
Uxbridge, Middlesex UB8 1NU  
£1,644 PCM**

**Deposit required £1,896**

**Available date 25th July  
2025**

**\*\*STUDENTS\*\***

**3 BEDROOMS - AVAILABLE 25/07/2025**

The rental payments equate to approx £548 per person per month or £126 per person per week excluding bills.

UniHomes offer a bills package for £29 per person per week. (Incl Gas, Electric, Water, TV licence and internet) which can be organised through Nupad initially.

Nupad offer this excellent Three-bedroom house comprising of THREE large FURNISHED BEDROOMS , a BATHROOM AND KITCHEN dining area. Outside there are communal gardens and parking.

The property is ideal for students at Brunel University as it is only 1.3 miles or 25-minute walk to campus. It is also nearby to direct bus routes to Uxbridge Town Centre, Heathrow, Stockley Park and the local underground station, which provides further access to Central London.

COUNCIL TAX BAND C  
EPC D

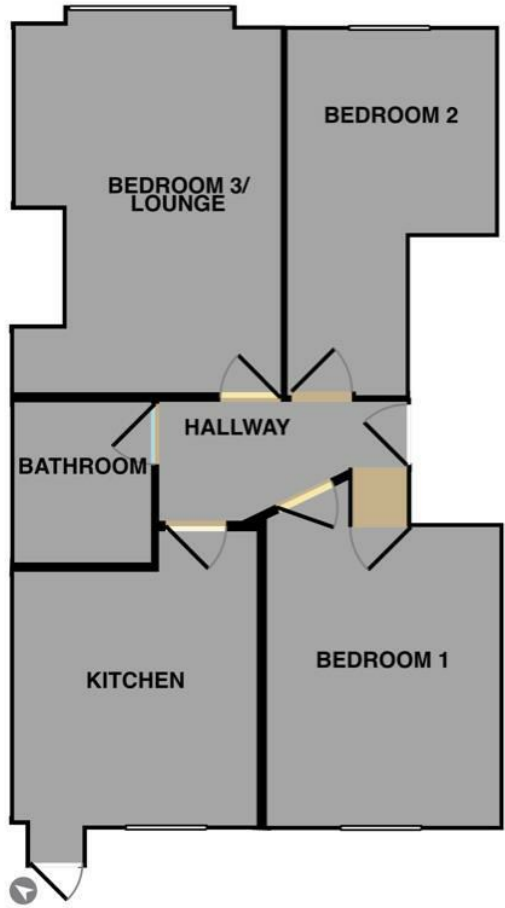

Energy Efficiency Rating		Current	Potential
Very energy efficient - lower running costs			
(92 plus) A			
(81-91) B			
(69-80) C			
(55-68) D			
(39-54) E			
(21-38) F			
(1-20) G			
Not energy efficient - higher running costs			
England & Wales	EU Directive 2002/91/EC	61	64

Environmental Impact (CO <sub>2</sub> ) Rating		Current	Potential
Very environmentally friendly - lower CO <sub>2</sub> emissions			
(92 plus) A			
(81-91) B			
(69-80) C			
(55-68) D			
(39-54) E			
(21-38) F			
(1-20) G			
Not environmentally friendly - higher CO <sub>2</sub> emissions			
England & Wales	EU Directive 2002/91/EC	56	60