



**6 Belgrave Mews  
Uxbridge, UB8 3AG**

**£2,308 PCM**

**Deposit required £2,663**

**Available date 26th August  
2025**

**\*\*STUDENTS\*\***

**4 BEDROOMS - AVAILABLE 26/08/2025**

The rental payments equate to approx £577 per person per month or £133 per person per week excluding bills. UniHomes offer a bills package for £25 per person per week. (Incl Gas, Electric, Water, TV licence and internet) which can be organised through Nupad initially.

COUNCIL TAX BAND D  
EPC C

Nupad offer this excellent FOUR-bedroom house comprising of FOUR FURNISHED BEDROOMS , a LOUNGE, BATHROOM AND KITCHEN facilities. The property is ideal for students at Brunel University as it's walking distance to the university. It is also nearby to direct bus routes to Uxbridge Town Centre, Heathrow, Stockley Park and the local underground station, which provides further access to Central London.

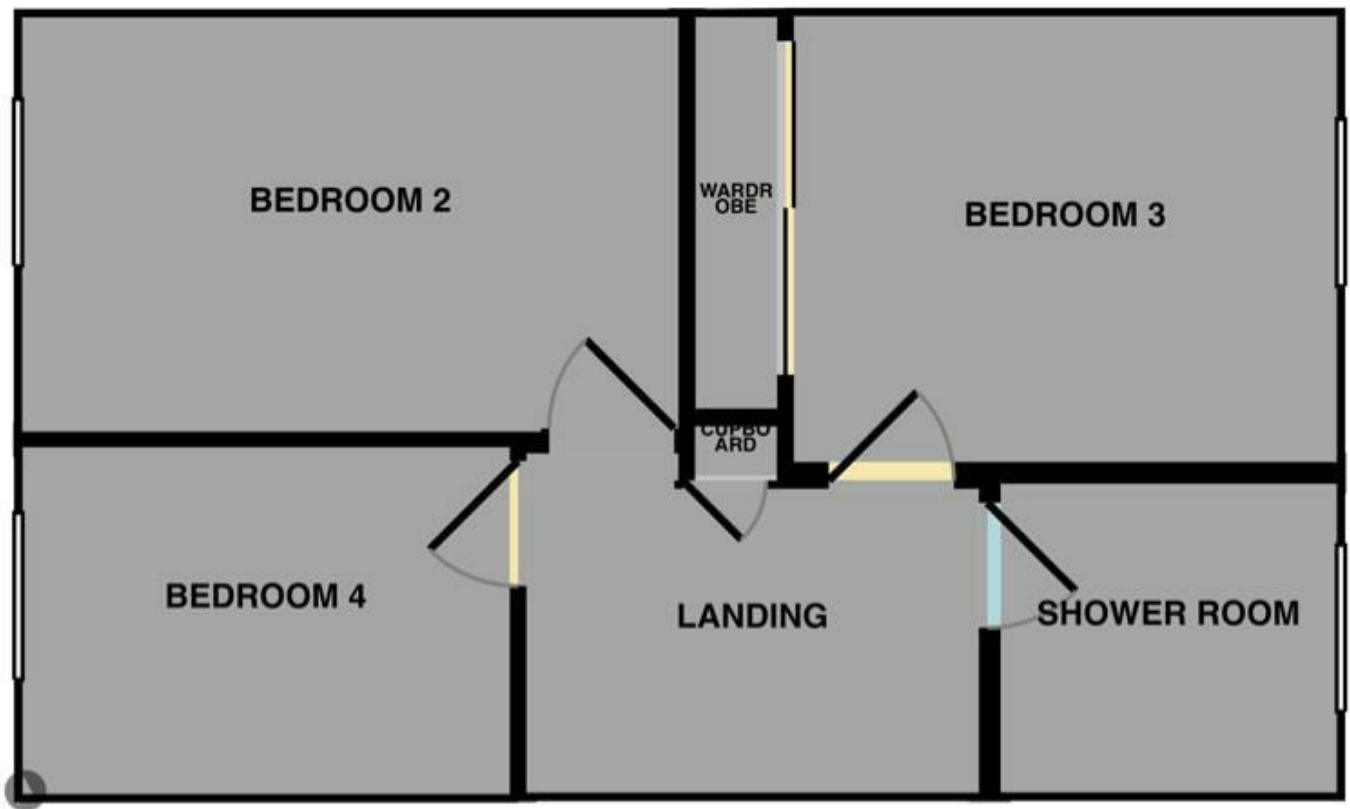
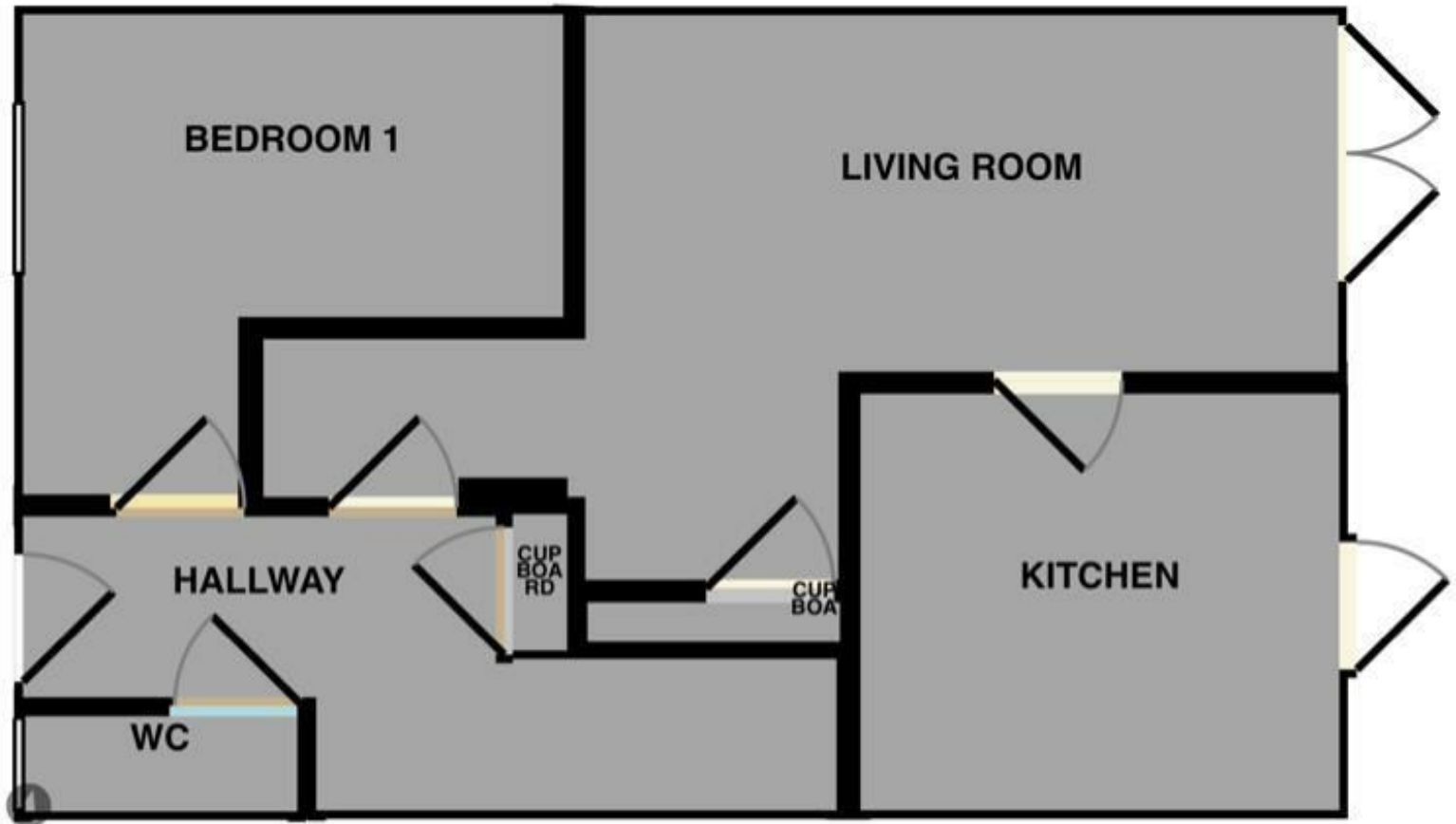

| Energy Efficiency Rating                    |  | Current | Potential |
|---|--|---------|-----------|
| Very energy efficient - lower running costs |  |         |           |
| (92 plus) A                                 |  |         |           |
| (81-91) B                                   |  |         |           |
| (69-80) C                                   |  |         |           |
| (55-68) D                                   |  |         |           |
| (39-54) E                                   |  |         |           |
| (21-38) F                                   |  |         |           |
| (1-20) G                                    |  |         |           |
| Not energy efficient - higher running costs |  |         |           |
| England & Wales                             |  | 73      | 86        |
| EU Directive 2002/91/EC                     |  |         |           |

| Environmental Impact (CO <sub>2</sub> ) Rating                  |  | Current | Potential |
|---|--|---------|-----------|
| Very environmentally friendly - lower CO <sub>2</sub> emissions |  |         |           |
| (92 plus) A   |  |         |           |
| (81-91) B   |  |         |           |
| (69-80) C   |  |         |           |
| (55-68) D   |  |         |           |
| (39-54) E   |  |         |           |
| (21-38) F   |  |         |           |
| (1-20) G  |  |         |           |
| Not environmentally friendly - higher CO <sub>2</sub> emissions |  |         |           |
| England & Wales   |  | 73      | 86        |
| EU Directive 2002/91/EC   |  |         |           |