



**8 Lodge Close  
Uxbridge, London UB8 2ES  
£2,572 PCM**

**Deposit required £2,828**

**Available date 20th August 2024**

**\*\*STUDENTS\*\***

**4 BEDROOMS - AVAILABLE 20/08/2024**

The rental payments equate to approx £613 per person per month or £141 per person per week excluding bills. UniHomes offer a bills package for £26 per person per week. (Incl Gas, Electric, Water, TV licence and internet) which can be organised through Nupad initially.

COUNCIL TAX BAND E  
EPC D

Nupad offer this excellent FOUR-bedroom house comprising of FOUR FURNISHED BEDROOMS, a LOUNGE area, 2 BATHROOMS one upstairs and one downstairs AND KITCHEN/Breakfast room, outside there is off street parking and an enclosed rear garden.

The property is ideal for students at Brunel University as it's walking distance to the university. It is also nearby to direct bus routes to Uxbridge Town Centre, Heathrow, Stockley Park and the local underground station, which provides further access to Central London.

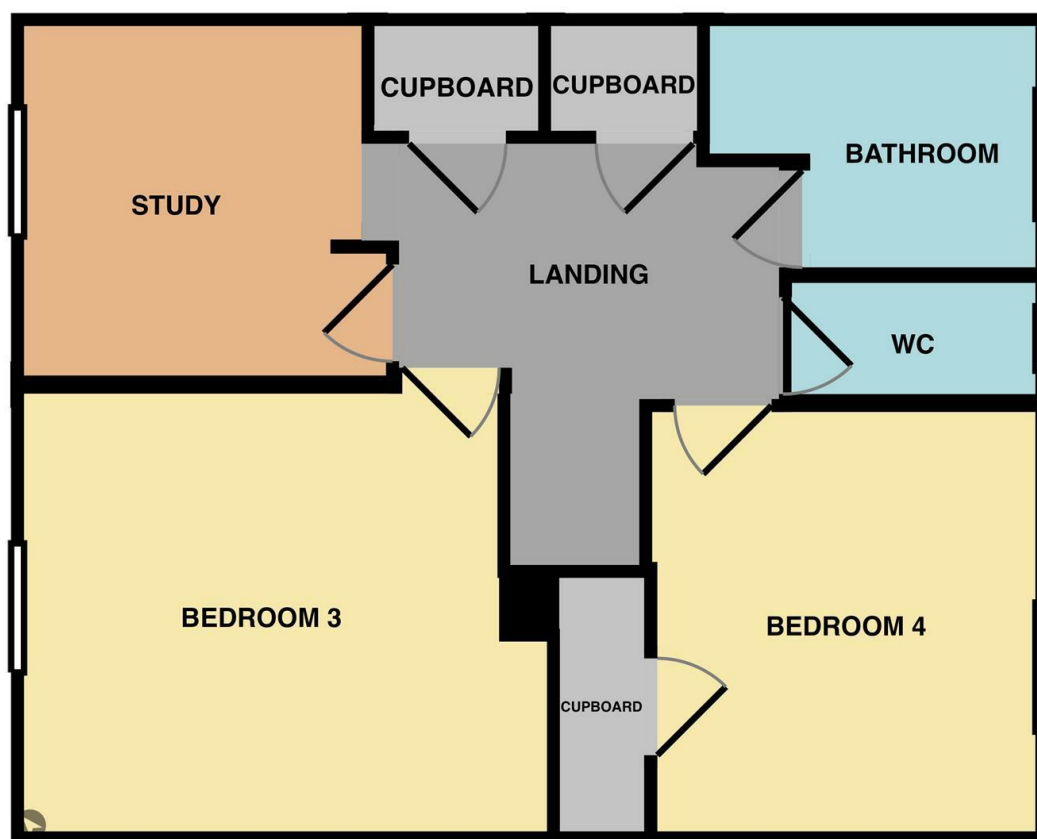

Energy Efficiency Rating		
	Current	Potential
Very energy efficient - lower running costs		
(92 plus) <b>A</b>		
(81-91) <b>B</b>		
(69-80) <b>C</b>		
(55-68) <b>D</b>		
(39-54) <b>E</b>		
(21-38) <b>F</b>		
(1-20) <b>G</b>		
Not energy efficient - higher running costs		
<b>England &amp; Wales</b>	EU Directive 2002/91/EC	

Environmental Impact (CO <sub>2</sub> ) Rating		
	Current	Potential
Very environmentally friendly - lower CO <sub>2</sub> emissions		
(92 plus) <b>A</b>		
(81-91) <b>B</b>		
(69-80) <b>C</b>		
(55-68) <b>D</b>		
(39-54) <b>E</b>		
(21-38) <b>F</b>		
(1-20) <b>G</b>		
Not environmentally friendly - higher CO <sub>2</sub> emissions		
<b>England &amp; Wales</b>	EU Directive 2002/91/EC	