



**23 Heritage Close
Uxbridge, UB8 2LA
£2,500 Per Month**

Deposit required £2,880

**Available date 15th
September 2025**

Nestled in the charming area of Heritage Close, Uxbridge, this delightful mid-terrace house offers a perfect blend of comfort and modern living. The property boasts four well-proportioned bedrooms, making it an ideal choice for families seeking extra space.

The property features two bathrooms, which is a significant advantage for busy households, allowing for convenience and privacy.

Heritage Close is a peaceful and friendly neighbourhood, providing a sense of community while being conveniently located near local amenities, schools, and transport links. This property presents an excellent opportunity for those looking to settle in a desirable area of Uxbridge, combining space, comfort, and potential in one attractive package.

FIRST FLOOR
456 sq.ft. (42.3 sq.m.) approx.

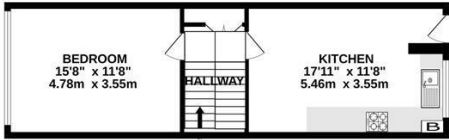

SECOND FLOOR
377 sq.ft. (35.0 sq.m.) approx.

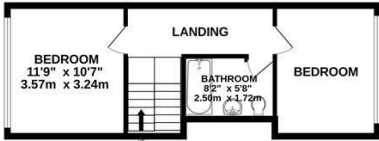

GROUND FLOOR
504 sq.ft. (46.9 sq.m.) approx.

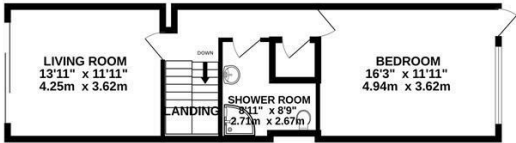

TOTAL FLOOR AREA: 1337 sq.ft. (124.2 sq.m.) approx.
Whilst every attempt has been made to ensure the accuracy of the floorplan contained here, measurements of doors, windows, rooms and any other items are approximate and no responsibility is taken for any error, omission or mis-statement. This plan is for illustrative purposes only and should be used as such by any prospective purchaser. The services, systems and appliances shown have not been tested and no guarantee as to their operability or efficiency can be given.
Made with Metropix i2025

Energy Efficiency Rating		
	Current	Potential
Very energy efficient - lower running costs		
(92 plus) A		
(81-91) B		
(69-80) C		
(55-68) D		
(39-54) E		
(21-38) F		
(1-20) G		
Not energy efficient - higher running costs		
England & Wales	EU Directive 2002/91/EC	

Environmental Impact (CO ₂) Rating		
	Current	Potential
Very environmentally friendly - lower CO ₂ emissions		
(92 plus) A		
(81-91) B		
(69-80) C		
(55-68) D		
(39-54) E		
(21-38) F		
(1-20) G		
Not environmentally friendly - higher CO ₂ emissions		
England & Wales	EU Directive 2002/91/EC	